

KNIFE GATE VALVE

Handwheel operated Type KG01W

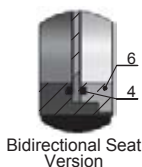

Handwheel operated (Flange PN10/ANSI class150)

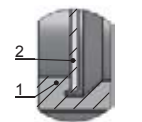
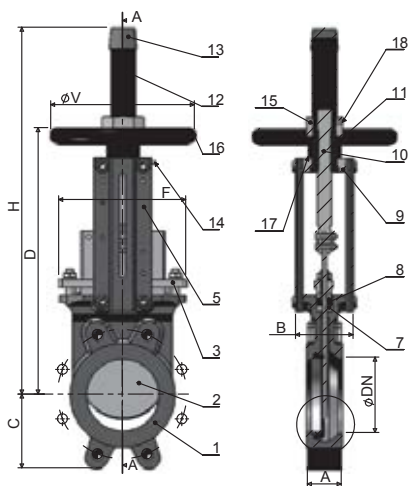

Body material temperature range	
Material	Temperature range
Cast iron	-15 to 250°C
Ductile iron	-30 to 350°C
Carbon steel	-29 to 425°C
Stainless steel	-196 to 600°C

Packing material temperature range	
Material	Temperature range
PTFE	0 to 180°C
Graphite	-10 to 650°C

Standard Flange Connection	
Sizes	Flange drilling
DN50-1200	EN 1092 PN 10 EN 1092 PN 16 ANSI B16.5 Class 150 ANSI B16.47 Class 150, serie A JIS B 2238 10K BS 10 Table D*

Standard Material Specifications			
POS	Name	CI Version	SS Version
1	Body	GG25	CF8M
2	Knife	SS304	SS316
3	Packing Gland	AL	CF8M
4	Seat	EPDM / Metal	EPDM / Metal
5	Support	STEEL	STEEL
6	Retainer	SS304	SS316
7	Packing	PTFE	PTFE
8	O-Ring	NBR	EPDM
9	Yoke	STEEL	STEEL
10	Spindle	SS303	SS303
11	Stem Nut	BRONZE	BRONZE
12	Hood	STEEL	STEEL
13	Hood Cover	PLASTIC	PLASTIC
14	Oil Hole	STEEL	STEEL
15	Fixing Screw	STEEL	STEEL
16	HandWheel	STEEL	STEEL
17	Washer	BRASS	BRASS
18	Fixing Screw	SS304	SS304

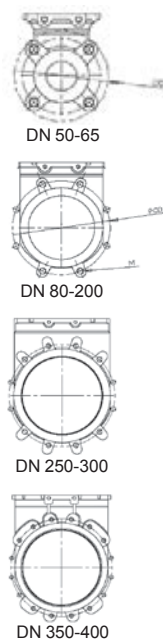

Dimensions (mm)							
DN	A	B	C	D	F	H	V
50	40	92	63	289	124	409	185
65	40	92	70	316	139	436	185
80	50	92	92	342	154	462	185
100	50	92	105	382	174	502	185
125	50	102	120	415	192	585	225
150	60	102	130	458	217	637	225
200	60	119	160	575	270	815	325
250	70	119	198	676	326	1016	325
300	70	119	234	776	380	1116	380
350	96	290	256	906	438	1336	450
400	100	290	292	1012	493	1442	450
450	106	290	308	1098	546	1628	450
500	110	290	340	1210	620	1740	450
600	110	290	400	1416	714	2046	450
700	110	320	452	1611	830	2461	620
800	110	320	505	1870	970	2820	620
900	110	320	555	2103	1040	3153	800
1000	110	320	610	2293		3443	800
1200	150	400	725				

Working pressure and temperature

Valve body is designed as per PN10.
 Pressure for shell test: 1.5 times maximum allowable working pressure for open valve.
 Pressure for seat tightness test: 1.1 times maximum allowable differential pressure for closed valve.

Standard working pressure table																			
DN	50	65	80	100	125	150	200	250	300	350	400	450	500	600	700	800	900	1000	1200
P (bar)	10	10	10	10	10	10	10	8	6	4	4	3	3	3	2	2	2	2	2

Important note: working pressure can be adjusted according to client's request.

Seat material temperature range			
Material	Temperature range	Application	To avoid
EPDM	-20 to 120°C	drinking water, acides,	grease, mineral oils
NBR	-10 to 90°C	oils & petroleum, abrasive, sea water	Oxidizing agents
FPM/VITON	-10 to 180°C	chemicals, ozone, oils and fat	
PTFE	0 to 180°C	Chemicals, solvents	
Silicone	-20 to 200°C	High temperature, food	Moist media
Metal seat		Depending on body & packing material	