

Atomac Lined Swing Check Valve Type ARK2

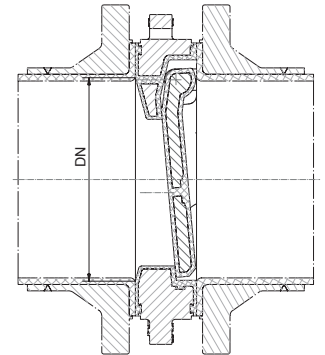
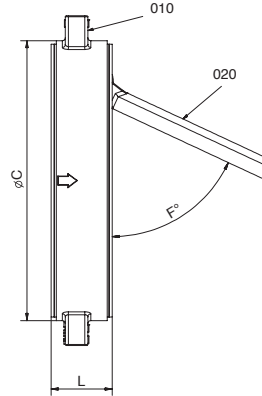
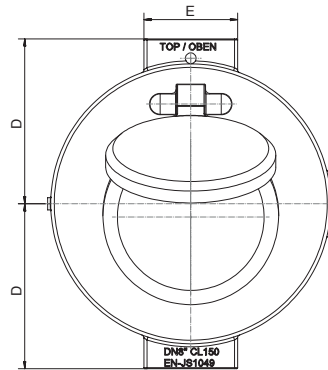

Flange Connections

ANSI B 16.5, 150lbs

*Available on DIN EN 1092-2, PN16

The fully PFA lined atomac swing check valves are ideal for use in highly corrosive applications and can replace swing check valves made from exotic alloys due to the universal chemical resistance of the fluoropolymer lining. These valves can be used in horizontal and vertical installations due to the special design of the hinge pin, which enables the disc to achieve a seal without support of any system pressure.

The ARK2 eliminates a potential leak path of conventional 3-piece and 2-piece designs with a seat face integrated in the body liner to seal against the disc in the closed position. The disc can swing freely within piping system without interference with the diameter of the connecting pipe.

Dimensions - mm.

SIZE	ANSI	ØA	ØB	ØC	D	E	L	F	ØR	S	Weight (kg)
2"	150#	98	25	101	70	66	43	62	48.5	3	2.2
3"	150#	130	45	133	85	89	46	65	75.5	3.5	3.8
4"	150#	164	66	170	105	54	52	65	98.1	4.5	6.6
6"	150#	215	105	219	135	70	56	65	149.3	5	11.1
8"	150#	268	144	275	162	92	60	63	193.5	6.5	18.2
10"	150#	324	184	336	198	69	68	65	246.4	7	29.8
12"	150#	386	230	406	234	87	78	62	293.7	8	49.8
14"	150#	429	250	445	255	95	78	62	321.6	9	62.1
16**	150#	482	300	510	290	77	102	58	368.8	10	104.4

* Face to Face dimensions: ANSI B 16.10 tab. 9 Sp. 4

Standard Material Specifications

No.	Description	Material
010	body	ductile cast iron with PFA (EN-JS1049 / ASTM A395) / FEP °
020	disc	ductile cast iron with PFA (EN-JS1049 / ASTM A395) / FEP °

° optional