

Atomac

# Lined 45° Ball Check Valve

Type ARL

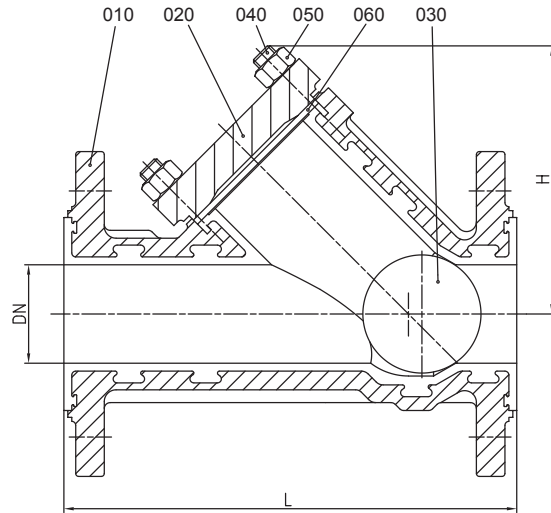

### Flange Connections

ANSI B 16 5, 150lbs

\*Available on DIN EN 1092-2 P10, P16

### ARL Lined 45° Ball Check Valve

This ball check valve can be installed either vertically or horizontally and offers an unobstructed flow due to the fact that the ball is pushed into the 45° cavity.

For applications where high medium flow turbulences can be expected, installation of an ARL check valve can be the ideal solution to avoid liner damages, as well as for use in horizontal pipes with low flow and low back-pressures.

### Dimensions - mm.

SIZE	ANSI	L	H	Weight (kg)
1"	150#	160	90	4.8
1½"	150#	200	120	9.2
2"	150#	230	136	12.2
3"	150#	310	206	20.5

### Standard Material Specifications

No.	Description	Material
010	body	ductile cast iron with PFA (EN-JS1049 / ASTM A395) / FEP °
020	flange	ductile cast iron with PFA (EN-JS1049 /ASTM A395)
030	ball	PTFE-solid ball (pure - PTFE)
040	stud bolt	stainless steel (1.4301 / ASTM A193 B8)
050	hexagon nut	stainless steel (1.4301 / ASTM A193 B8)
060	flat gasket	PTFE

° optional



@ALPHAGROUP



0-2792-9333



www.alphagroup.co.th