

Atomac  
**Lined Ball Check Valve**  
 Type ARV2

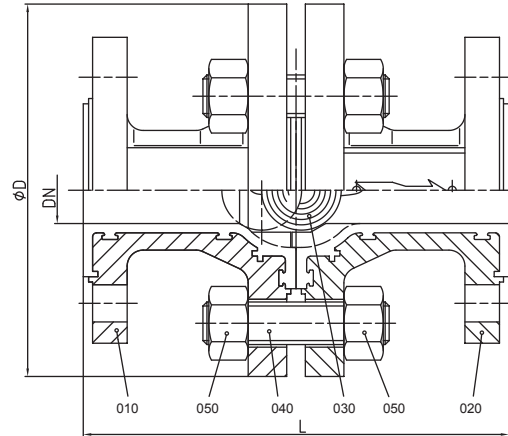
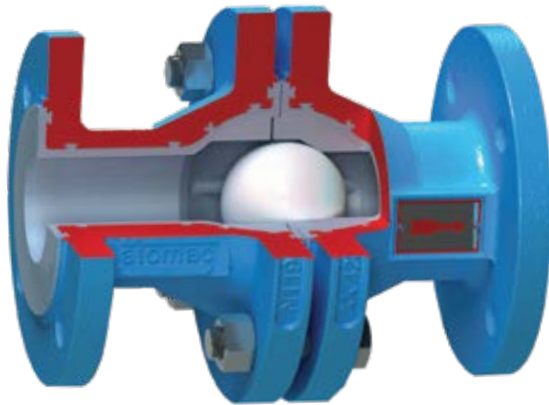

**Flange Connections**

**ANSI B 16 5, 150lbs**

\*Available on DIN EN 1092-2, PN16

**Lined Ball Check Valve\***

This two piece body designed check valve provides high stability, rigidity and eliminates potential leak path and can be installed either vertically and dependent upon application horizontally as well. Ball material consists of solid PTFE. Liner materials such as FEP, PFA and conductive PFA have outstanding corrosion resistant properties.

The ARV2 can be considered as a full port design which offers excellent flow characteristics.

Low opening pressure is needed to unseat the ball in then vertical position.

\*Optional PTFE hollow ball/spring supported/PFA-conductive

**Dimensions - mm.**

SIZE	ANSI	L	ØD	Weight (kg)
½"	150#	131	105	3.4
¾"	150#	150	105	3.8
1"	150#	152.4	140	6.0
1½"	150#	178	165	9.3
2"	150#	203	185	13.2
3"	150#	241	250	28.0
4"	150#	292	285	42.0
6"	150#	356	395	78.0
8"	150#	457	515	166.0

**Standard Material Specifications**

No.	Description	Material
010	body piece	ductile cast iron with PFA (EN-JS1049 / ASTM A395) / FEP °
020	body piece	ductile cast iron with PFA (EN-JS1049 / ASTM A395) / FEP °
030	ball	PTFE-solid ball (pure - PTFE)
040	stud bolt	stainless steel (1.4301 / A193 B8)
050	hexagon nut	stainless steel (1.4301 / A194 8)

° optional